

General Description

EMISSION CONTROL (AUX. EMISSION CONTROL DEVICES)

1. General Description

A: COMPONENT

1. CANISTER, PURGE CONTROL SOLENOID VALVE, AND LEAK CHECK VALVE ASSEMBLY

For components of canister, purge control solenoid valve, and leak check valve assembly, refer to FU(w/o STI). <Ref. to FU(w/o STI)-3, COMPONENT, General Description.>

2. EXHAUST GAS RECIRCULATION CONTROL CIRCUIT RANGE/PERFORMANCE

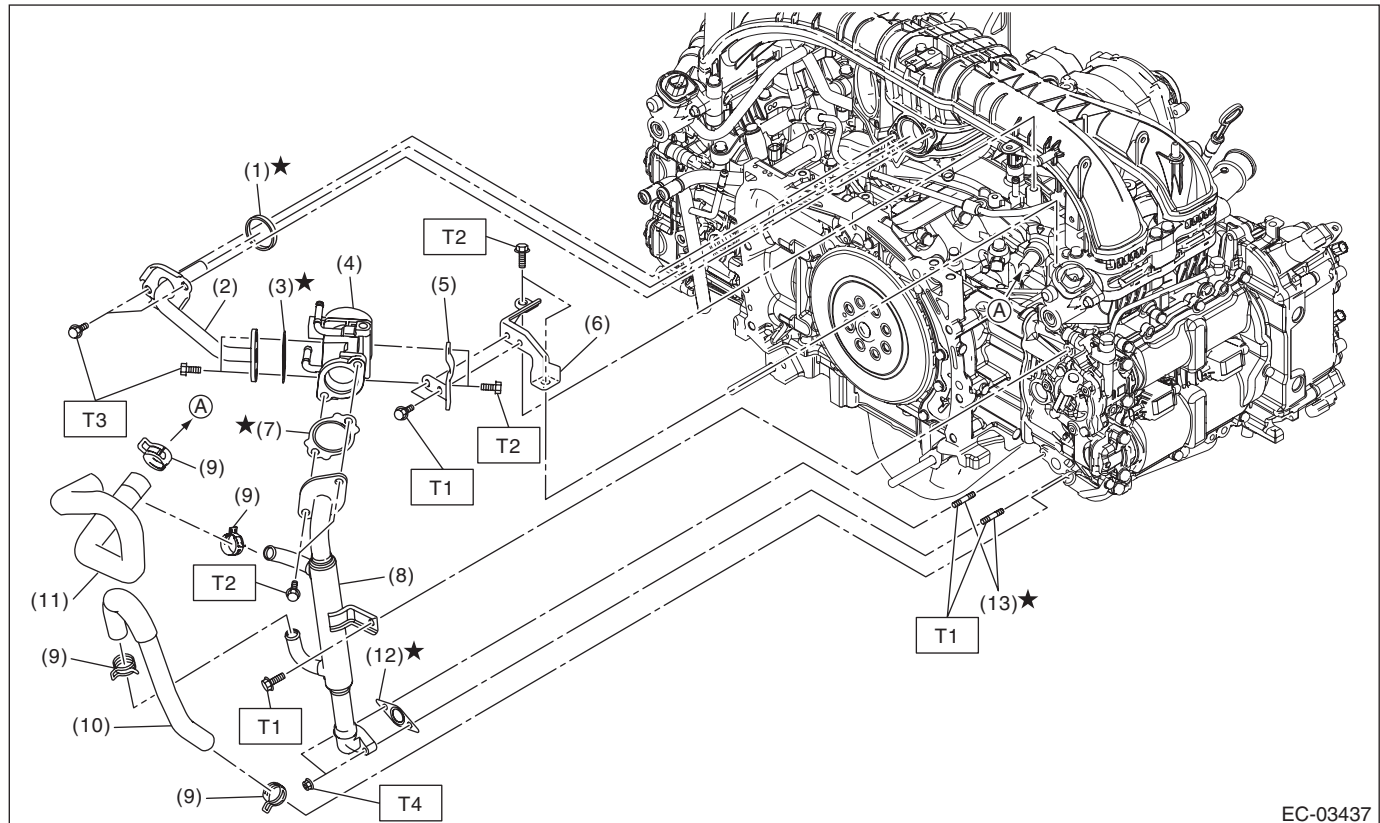

EC-03437

- | | |
|---------------------------------|------------------------------|
| (1) O-ring | (8) EGR cooler |
| (2) EGR pipe | (9) Clip |
| (3) Gasket | (10) Water hose A |
| (4) EGR control valve | (11) Water hose B (MT model) |
| (5) EGR control valve bracket A | (12) Gasket |
| (6) EGR control valve bracket B | (13) Stud bolt |
| (7) Gasket | |

Tightening torque: N-m (kgf-m, ft-lb)

T1: 6.4 (0.7, 4.7)

T2: 19 (1.9, 14.0)

T3: <Ref. to EC(w/o STI)-33, INSTALLATION, EGR Pipe.>

T4: <Ref. to EC(w/o STI)-43, INSTALLATION, EGR Cooler.>

General Description

EMISSION CONTROL (AUX. EMISSION CONTROL DEVICES)

3. PCV SYSTEM 1

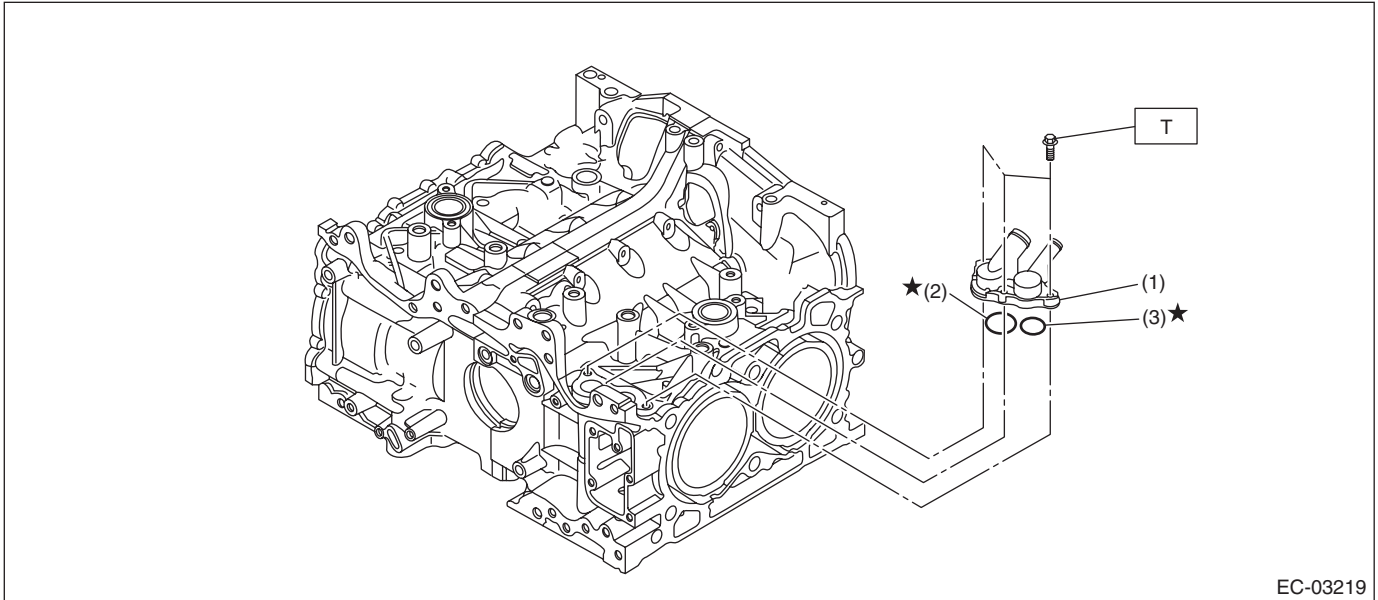

- (1) PCV connector
- (2) O-ring

- (3) O-ring

Tightening torque: N·m (kgf·m, ft·lb)

T: 6.4 (0.7, 4.7)

General Description

EMISSION CONTROL (AUX. EMISSION CONTROL DEVICES)

4. PCV SYSTEM 2

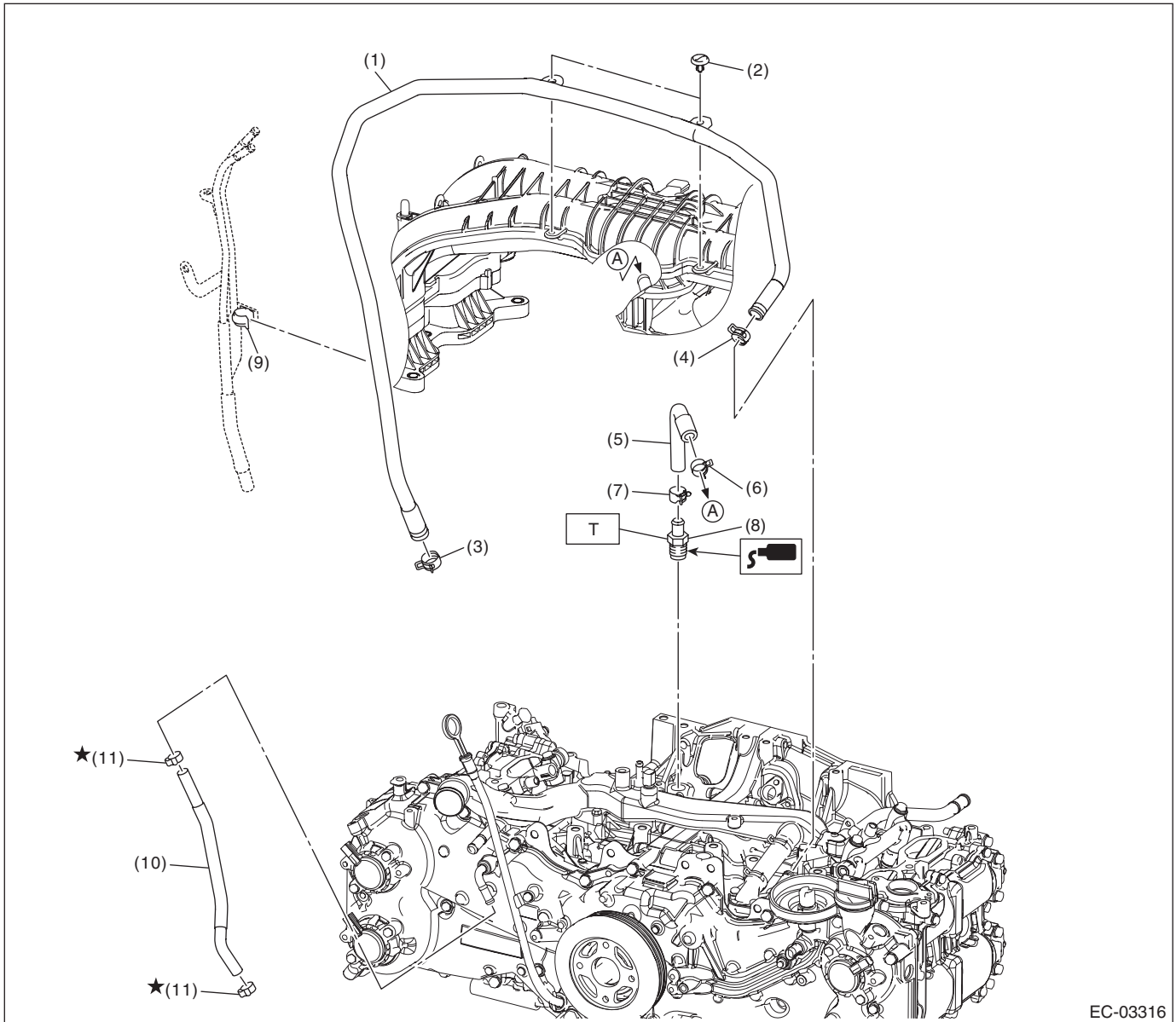

- (1) PCV pipe
- (2) Clip
- (3) Clip
- (4) Clip
- (5) PCV hose A

- (6) Clip
- (7) Clip
- (8) PCV valve
- (9) Clip
- (10) PCV hose B

- (11) Clamp

Tightening torque: N-m (kgf-m, ft-lb)

T: 23 (2.3, 17.0)

General Description

EMISSION CONTROL (AUX. EMISSION CONTROL DEVICES)

B: CAUTION

- Prior to starting work, pay special attention to the following:
 1. Always wear work clothes, a work cap, and protective shoes. Additionally, wear a helmet, protective goggles, etc. if necessary.
 2. Protect the vehicle using a seat cover, fender cover, etc.
 3. Prepare the service tools, clean cloth, containers to catch grease and oil, etc.
- Vehicle components are extremely hot immediately after driving. Be wary of receiving burns from heated parts.
- When performing a repair, identify the cause of trouble and avoid unnecessary removal, disassembly and replacement.
- Before disconnecting connectors of sensors or units, be sure to disconnect the ground cable from battery.
- Always use the jack-up point when the shop jacks or rigid racks are used to support the vehicle.
- Remove contamination including dirt and corrosion before removal, installation, disassembly or assembly.
- Keep the removed parts in order and protect them from dust and dirt.
- All removed parts, if to be reused, should be reinstalled in the original positions with attention to the correct directions, etc.
- Bolts, nuts and washers should be replaced with new parts as required.
- Be sure to tighten the fasteners including bolts and nuts to the specified torque.

C: PREPARATION TOOL

1. SPECIAL TOOL

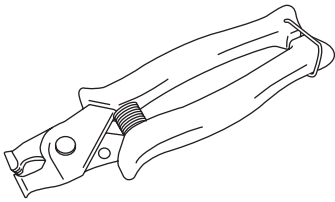
| ILLUSTRATION | TOOL NUMBER | DESCRIPTION | REMARKS |
|--|-------------|--------------|--|
|  ST18353AA000 | 18353AA000 | CLAMP PLIERS | <ul style="list-style-type: none">• Used for removing and installing the PCV hose assembly.• This tool is made by the French company CAILLAU. (code) 54.0.000.205 To make it easier to obtain, it has been provided with a tool number. |

2. GENERAL TOOL

| TOOL NAME | REMARKS |
|----------------|--|
| Circuit tester | Used for measuring resistance and voltage. |